



NORTH WEST LEICESTERSHIRE DISTRICT COUNCIL

PREMISES LICENCE

Premises Licence Number

NWL20418

Part 1 – Premises Details

Postal address of premises, or if none, ordnance survey map reference or description, including Post Town, Post Code

The Halfway House
65 Church Street
Donisthorpe
Swadlincote
Derby
DE12 7PX

Telephone number 01530 588783

Where the licence is time limited the dates

Not applicable

Licensable activities authorised by the licence and the times the licence authorises the carrying out of licensable activities

Supply by retail of alcohol	Monday to Thursday	10:00 – 00:01 hrs
	Sunday	11:00 - 00:01 hrs
	Friday and Saturday	10:00 - 01:00 hrs
	New Years Eve	11:00 - 11:00 hrs next day
	New Years Day	12:00 - 00:30 hrs
Provision of Indoor Sporting Events	Monday to Saturday	19:00 - 23:00 hrs
	Sunday	10:00 - 22:00 hrs
Playing of Recorded Music Indoors	Sunday to Thursday	12:00 - 00:01 hrs
	Friday and Saturday	12:00 - 01:00 hrs
Late Night Refreshment	Sunday to Thursday	23:00 - 00:01 hrs
	Friday and Saturday	23:00 - 01:00 hrs
	New Years Eve	23:00 - 11:00 next day
	New Years Day	23:00 - 00:30

The opening hours of the premises

Monday - Thursday	10:00 00:01 hrs
Friday & Saturday	10:00 01:00 hrs
Sunday	11:00 00:01 hrs

Where the licence authorises supplies of alcohol whether these are on and / or off supplies

The sale by retail of alcohol for consumption on and off the premises.

Part 2

Name, (registered) address, telephone number and email (where relevant) of holder of premises licence

Mr Paul Aldred & Mr Peter Riley

Registered number of holder, for example company number, charity number (where applicable)

Name, address and telephone number of designated premises supervisor where the premises licence authorises for the supply of alcohol

Paul William John Aldred

Telephone Number:

Personal licence number and issuing Authority of personal licence held by designated premises supervisor where the premises licence authorises for the supply of alcohol

PERSONAL LICENCE NUMBER OF DPS: SDDC/001855

ISSUING AUTHORITY: South Derbyshire District Council

Dated: 11th November 2010

**Andrew Cooper
Licensing Enforcement Officer**

Annex 1 – Mandatory conditions

- 1 No supply of alcohol may be made under the premises licence;
 - a) at a time when there is no designated premises supervisor in respect of the premises licence, or
 - b) at a time when the designated premises supervisor does not hold a personal licence or his personal licence is suspended.
- 2 Every supply of alcohol must be made or authorised by a person who holds a personal licence.

Mandatory conditions coming into force from 6th April 2010:

1.
 - (1) The responsible person shall take all reasonable steps to ensure that staff on relevant premises do not carry out, arrange or participate in any irresponsible promotions in relation to the premises.
 - (2) In this paragraph, an irresponsible promotion means any one or more of the following activities, or substantially similar activities, carried on for the purpose of encouraging the sale or supply of alcohol for consumption on the premises in a manner which carries a significant risk of leading or contributing to crime and disorder, prejudice to public safety, public nuisance, or harm to children—
 - (a) games or other activities which require or encourage, or are designed to require or encourage, individuals to—
 - (i) drink a quantity of alcohol within a time limit (other than to drink alcohol sold or supplied on the premises before the cessation of the period in which the responsible person is authorised to sell or supply alcohol), or
 - (ii) drink as much alcohol as possible (whether within a time limit or otherwise);
 - (b) provision of unlimited or unspecified quantities of alcohol free or for a fixed or discounted fee to the public or to a group defined by a particular characteristic (other than any promotion or discount available to an individual in respect of alcohol for consumption at a table meal, as defined in section 159 of the Act);
 - (c) provision of free or discounted alcohol or any other thing as a prize to encourage or reward the purchase and consumption of alcohol over a period of 24 hours or less;
 - (d) provision of free or discounted alcohol in relation to the viewing on the premises of a sporting event, where that provision is dependent on—
 - (i) the outcome of a race, competition or other event or process, or
 - (ii) the likelihood of anything occurring or not occurring;
 - (e) selling or supplying alcohol in association with promotional posters or flyers on, or in the vicinity of, the premises which can reasonably be considered to condone, encourage or glamorise anti-social behaviour or to refer to the effects of drunkenness in any favourable manner.
2. The responsible person shall ensure that no alcohol is dispensed directly by one person into the mouth of another (other than where that other person is unable to drink without assistance by reason of a disability).
3. The responsible person shall ensure that free tap water is provided on request to customers where it is reasonably available.

Mandatory conditions coming into force from 1st October 2010:

1. (1) The premises licence holder or club premises certificate holder shall ensure that an age verification policy applies to the premises in relation to the sale or supply of alcohol.

(2) The policy must require individuals who appear to the responsible person to be under 18 years of age (or such older age as may be specified in the policy) to produce on request, before being served alcohol, identification bearing their photograph, date of birth and a holographic mark.
2. The responsible person shall ensure that –
 - (a) where any of the following alcoholic drinks is sold or supplied for consumption on the premises (other than alcoholic drinks sold or supplied having been made up in advance ready for sale or supply in a securely closed container) it is available to customers in the following measures –
 - (i) beer or cider: ½ pint;
 - (ii) gin, rum, vodka or whisky: 25 ml or 35 ml; and
 - (iii) still wine in a glass: 125 ml; and
 - (b) customers are made aware of the availability of these measures.

Annex 2 – Conditions consistent with the Operating Schedule

- 1 The licence holders and their employees will remain aware of the licensing objectives and ensure that they are reflected in the way the premises are run.
- 2 Trained staff will be vigilant in watching for any criminal activity including the carrying of knives and the use of drugs.
- 3 Fire fighting equipment will be installed and regularly tested with electrical installations.
- 4 The licence holders will take steps to ensure that customers behave within the premises and when leaving it in endeavour to keep noise, nuisance and litter to a minimum. Notices will be put up in the premises and in the car park to advise customers to leave quietly and with due consideration for local residents.
- 5 Children will only be allowed onto the premises when accompanied by a responsible adult. Bar staff will be instructed in age-identification procedures and the production of appropriate evidence of age.
- 6 No children will be allowed on the premises after 21:00 hours.

Annex 3 – Conditions attached after a hearing by the licensing authority

Annex 4 – Plans

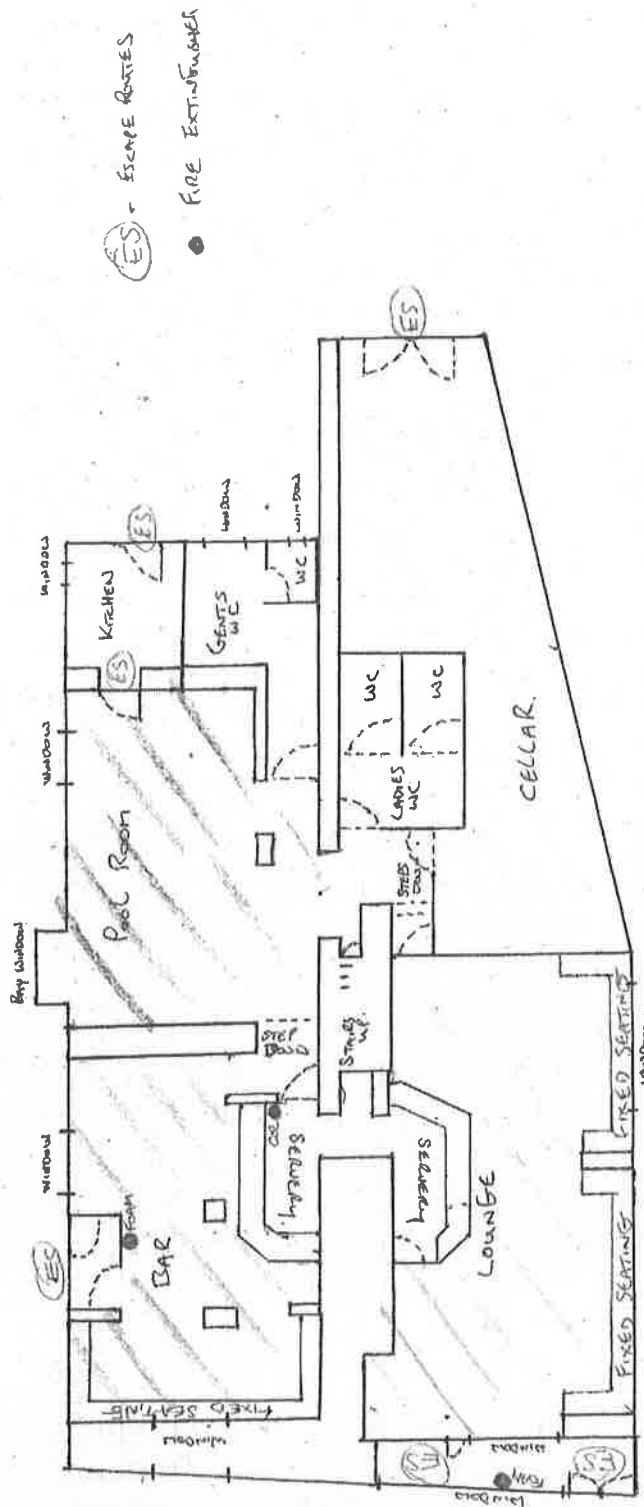

ES - ESCAPE ROUTES
 F - FIRE EXTINGUISHER

BAR AREA FOR CONSUMPTION OF ALCOHOL AND ALL LICENSABLE ACTIVITY
 LOUNGE + ENTERTAINMENTS AREA FOR CONSUMPTION OF ALCOHOL AND ALL LICENSABLE ACTIVITY
 Games Room. AREA FOR CONSUMPTION OF ALCOHOL AND ALL LICENSABLE ACTIVITY
 CELLAR
 TURKS HEAD
 1:100 SCALE.